

EVENT GUIDE

WELCOME TO A WORLD OF REFINED ELEGANCE AND SUMPTUOUS SURROUNDINGS



If you appreciate the finer things in life, an event at Lincoln Estates will not disappoint. Our properties comprise of some of the most prestigious fine dining restaurants and award-winning event spaces in and around the GTA.

When we forayed into the world of fine dining back in 1977 with the opening of Buccaneer Seafood & Steakhouse, little could we have imagined where this incredible journey would take us. Our Estate properties over the years included prestigious GTA classics The Old Barbour House, Gatsby's, Terrace on the Green and Edgewater Manor. From luxurious lakeside mansions to countryside estates, extensive grounds featuring waterfalls and gazebos, to castle like vineyards; whatever the size of your event, we have you covered.

With an emphasis on opulent décor curated from across the world, creative culinary concoctions, high quality ingredients, outstanding customer service and breathtaking backdrops; we provide an experience as opposed to just an event. Our Domakin properties offer gourmet steaks and fresh seafood with an extensive selection of fine wines which have been hand-picked by our in-house sommelier.

Our promise is to deliver a fully customizable, lavish event as unique as you, whatever the occasion. When you book a special event at one of our properties, we are embarking on a relationship for life, ready to help celebrate every future milestone.

The Trajkovski Family



AWARD WINNING CUISINE



Fine Dining

With our award-winning fine dining restaurant Edgewater Manor, our talented culinary team have created a unique menu for our Lincoln Estates events featuring locally sourced ingredients and a creative twist on classic dishes.

Nestled amongst our 10 acres of vineyards, our guests have the option of complimenting their meal with one of our very own Core wines or they can choose from our extensive wine selection that has been hand-picked from around the world for its unique attributes by our in-house sommelier.

Learn more at www.lincolnestates.ca

Venue Location (visits by appointment only)
3870 Tintern Road, Vineland



SPACES

TENTED EVENT



Outdoor Tent

Seating Capacity: 150

Features: Overlooks our vineyards, manicured lawns, patio area with seating, scenic backdrop of our pond, fully licensed for alcohol service

Patio

Seating Capacity: 30 Standing Capacity: 60

Features: Overlooks our vineyards, pond and grounds

West Wing

Seating Capacity: 30 Standing Capacity: 60

South Wing

Seating Capacity: 24 Standing Capacity: 50

The Cellar

Seating Capacity: 20 Standing Capacity: 50

Features: Lower level (accessible by stairs only)



LINCOLN ESTATES

EVENT SPACE

A UNIQUE DESTINATION



ALL EVENTS OVER 30 GUESTS ARE HELD OUTDOORS

If you have ever wished to have an event in your very own fairytale castle then Lincoln Estates offers the opportunity to make your dream come true.

We offer a variety of different options for your special event and aim to make each one a unique and elegant affair.

Nestled among a private 10-acre vineyard not open to the public; home to our Core winery, once you cross the bridge you are immediately swept away by the grandeur of Lincoln Estates.

Our bright and airy outdoor tent accommodates up to 150 guests and our decedent private dining rooms, wine cellar and sprawling grounds offer an abundance of breathtaking backdrops for your photography.

Our goal at Lincoln Estates is to create a memorable experience for you and your guests, that couple luxurious settings with award winning fine dining, catered by Edgewater Manor.

Discover why we are one of the most highly acclaimed, top secret special event destinations and give your guests something to talk about for years to come.

NO OVERNIGHT ACCOMODATIONS



LINCOLN
ESTATES

EVENT OPTIONS

ALL EVENTS OVER 30 GUESTS ARE HELD OUTDOORS



Up to 150 guests

INSIDE

Seated: 10-30 guests
Standing: 10-60 guests

OUTSIDE TENT

Seated: 40-150 guests

Pricing based on minimum adult guest count and venue fee

Other Location

Check availability at our lakeside mansion, Edgewater Manor which can accommodate up to 100 guests



EVENT PACKAGES

ALL FOOD OPTIONS NEED TO BE PRE-SELECTED



FOR WEDDINGS PLEASE REFER TO WEDDING PACKAGE BROCHURE

Event Menus (lunch & dinner)

MENU B

\$79 p.p

+ beverages, tax & gratuity (18%)

SOUP

Daily Soup

SALAD

Edgewater Salad

CHOICE OF ENTREE

12oz USDA Prime NY Steak

Chicken Supreme

Daily Fish

DESSERT

2 Daily Desserts

Coffee/Tea

MENU C

\$89 p.p

+ beverages, tax & gratuity (18%)

Antipasto Plate

SALAD

Edgewater Salad

CHOICE OF ENTREE

8oz Filet Mignon

Chicken Supreme

Daily Fish

DESSERT

Choice of 2 Daily Desserts

Coffee/Tea

MENU D

\$99 p.p

+ beverages, tax & gratuity (18%)

SALAD

Edgewater Salad

APPETIZER

Shrimp Cocktail

Crispy Goat Cheese

CHOICE OF ENTREE

12oz USDA Prime NY Steak

Rack of Lamb

Daily Fish

Chicken Supreme

DESSERT

Choice of 2 Daily Desserts

Coffee/Tea

**PLEASE ENQUIRE
FOR A CUSTOM MENU**

Venue fee applicable based on date and guest count

INCLUDED IN YOUR EVENT

****INTERIORS CURRENTLY UNDER RENOVATION. OUR NEW LOOK WILL BE UNVEILED JUNE 1ST****



- Outdoor space, standard chairs, grounds for photos
- On-site food & beverage planner & all event staff
- Private suite within package hours (added fee for extended use)
- Menu tasting (based on size of event)
- Standard chairs, tables, white linens, cruiser tables, gift table

Reductions

- \$25 reduction for no alcohol events
- \$75 reduction for kids (kids menu & soft bar)

Payments

- \$2k deposit to secure date (non-refundable after signing contract)
- \$2k due at signing of contract (non-refundable)
- \$2k due 6 months before event
- \$1k damage fee (will be refunded 7 days after event if no incidentals)
- Balance due 2 weeks before event (certified cheque/EMT/+2.5% for credit card payment)
- Outside vendor setup/tear down must be within your event hours & pre-authorized
- No cash bar

Note
If you cancel and we can rebook the space for a comparable sized event your money will be returned.



REGULATIONS

SOME DO'S AND DON'T FOR EVENTS HELD AT EDGEWATER MANOR



VENDORS

- Vendor set up and teardown time needs to occur within your allotted event hours
- Bands – maximum 3 piece band
- DJ's – standard music set up (we supply table only) DJ needs to bring all equipment

OUTDOOR RULES

- No confetti/fake petals/glitter – only fresh petals& bubbles allowed
- All outdoor furniture rentals, décor or fixtures need prior approval (excluding flowers)
- All floral decor must be taken down during teardown and disposed of off site
- No amplified music outdoors past 10pm due to noise violations

DECOR

- Standard house chairs, cutlery and décor included in booking
- \$2500 venue set up and tear fee applicable if bringing own chair rentals/cutlery etc



PRICING STRUCTURE

VENUE FEE

OPERATING TIMES May 1st – Sep 30th & holidays

DAYTIME 10am–3pm: \$500

EVENING 5pm–12am:

Mon–Thur: \$1,000

Fri & Sun: \$1,500

Sat & long weekend Sun: \$2,000

ALL DAY 12pm–12am

Mon–Thur: \$1,500

Fri & Sun: \$2,500

Sat & long weekend Sun: \$3,500

FOOD & BEVERAGE MINIMUM SPEND (YEAR ROUND)

FRI, SAT, SUN & HOLIDAYS

\$175 p.p

MON-THUR

\$100 p.p

Prices exclude taxes and service charges

ADDITIONS

WINE CELLAR: TBC

RECEPTION/BREAKOUT ROOMS: TBC

SERVICE CHARGE

A 20% service charge will be added to your event which covers staffing and labour

FAQ

Do you offer corporate packages?

Lincoln Estates is the perfect private venue to accommodate corporate days out with options for breakout rooms, corporate bbqs, galas, outdoor games and wine tasting. With sprawling private grounds, if you can think of something, just ask and we would be happy to work with your event coordinator.

Can I rent Lincoln Estates for a wellness retreat?

Lincoln Estates has the capacity to accommodate large outdoor events for yoga/fitness classes, smaller breakout rooms for talks and mingling, with a focus of being surrounded by nature. Whilst we have no overnight accommodations, there are several hotels in the area we would be happy to recommend. Please feel free to reach out regarding usage.

What is your policy regarding the use of off-site caterers/ a private chef?

Off-site caterers/a private chef will incur a fee based on the level of their needs i.e. kitchen/equipment use, use of plates and cutlery, use of serving staff. Please enquire regarding pricing. If you are using outside caterers or a private chef, you will need to supply your own insurance.

Do you allow firework displays for private events?

Fireworks are not currently permitted at Lincoln Estates.

Do you allow children, and if so, what are their food options?

Whilst Lincoln Estates is an event space with a focus of fine dining, we can cater to our young guests and are happy to discuss several options to satisfy their needs.

Can I use my own photographer?

Absolutely, and you have access to the grounds and interiors of the venue which feature a pond, castle and vineyards. If you are looking for a photographer, we have several preferred vendors that we would be happy to recommend. If you are interested in using Lincoln Estates for photography only (without an event), please enquire to find out our rate based on the date and availability.

Do you have on-site parking and are you wheelchair accessible?

Lincoln Estates is a private estate with ample free on-site parking and whilst the outdoors is wheelchair accessible, please note that the bathrooms are inside the building which is not currently wheelchair friendly. Future plans include making the inside building accessible.

Can you accommodate guests with allergies and dietary restrictions?

All of our food is made from scratch and pre ordered meaning we can discuss options for any allergies or dietary restrictions such as gluten free, vegan, vegetarian and halal.

What is your policy on the use of drones and confetti?

Drones are permitted, as long as they are used in the grounds only and away from the exterior of the building. Only biodegradable products such as flower petals and bubbles are permitted in the grounds in lieu of confetti.

TENT SPECS

ALL EVENTS OVER 30 GUESTS ARE HELD OUTDOORS

45' X 55' M

EXTERIOR VIEWS

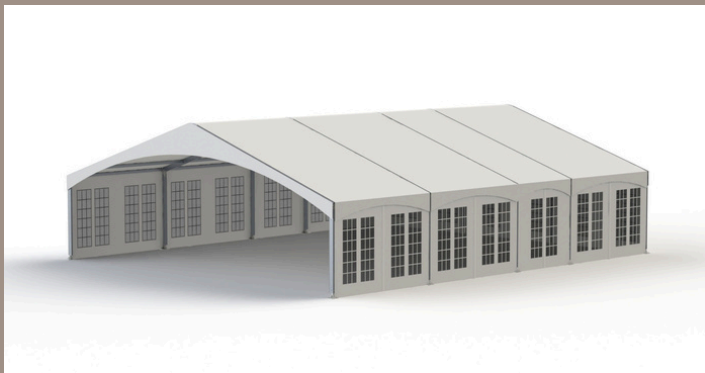

45' X 55' M

EXTERIOR VIEWS

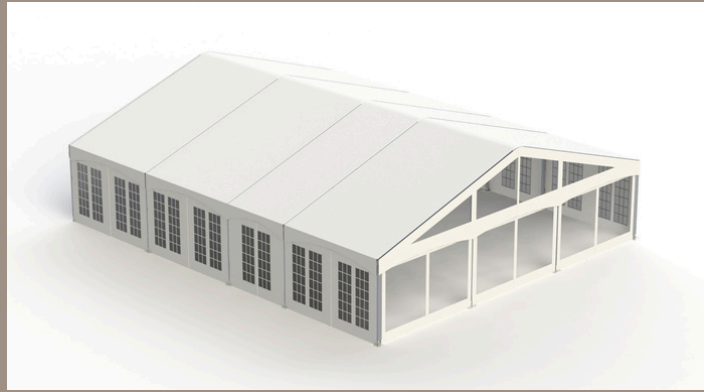

45' X 55' M

DIMENSIONS

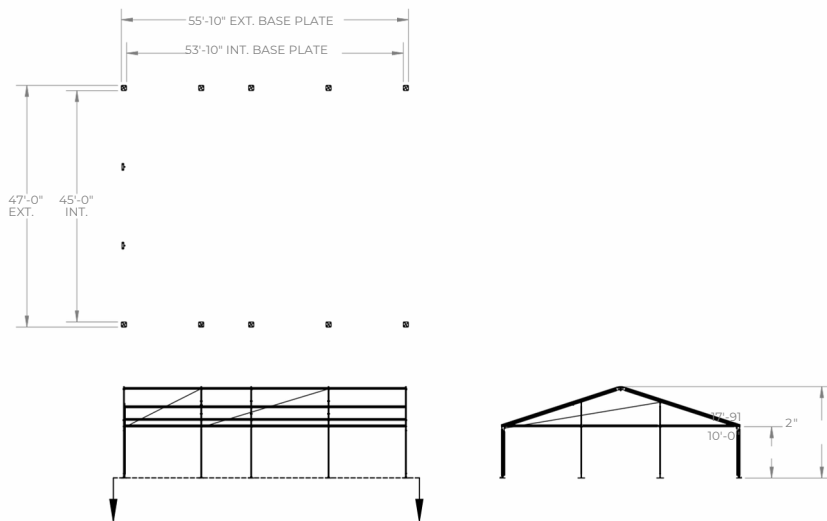

FLOOR PLAN (TENT)

Head table of 10
Guest seating for 150
using 14 - 72" round tables

